

# BUTLER® MANHOLE COVER REPLACEMENT PARTS

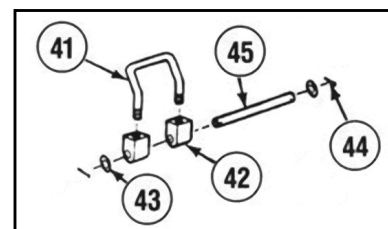

ITEM	PART #	DESCRIPTION
1	C-901559	Cover, Blank
2	C-070094	Hold Down Lug
3	B-902370	Upper Hinge
4	A-901603	Gasket, Black
	070099	Gasket, White
5	B-901546	Gasket Retainer Lug (Includes O-Ring)
6	7025	Hex Head Bolt, 3/8" - 16 x 1 1/4" S.S.
7	7107	Two Way Locknut, 3/8" S.S.
8	7077	Flat Washer, 3/8" S.S.
9	319665	O-Ring, FDA White
10	7080	Washer, EPDM Backed, 3/8" S.S.
11	C-904191	Collar, 6" tall
12	B-070096	Cam
13	B-070097	Pivot Block
14	A-070098	Eye Bolt
15	A-070465	Pivot Block Bracket
16	A-381571	L.H. Hinge Bracket
17	A-381572	R.H. Hinge Bracket
18	A-384282	Hinge Pin, 1/2" Diameter x 5"
19	A-070468	Pivot Block Pin, 1/2" Diameter x 2 7/8"
20	096241	Jam Nut, 1/2" - 13
21	096208	Cotter Pin
22	7024 / 7107	Hex Head Bolt, 3/8" - 16 x 1" with Locknut S.S.
23	C-384280	Safety Latch Assembly (see to the right)
24	A-070469	Cam Pin, 1/2" Diameter x 2 1/4"
25	7080	Washer, EPDM Backed, 3/8" S.S.
26	3508	Decal, Danger Do Not Open
	315294	Manhole Service Kit (Items 13, 14, 19, 20, 21, 24)
	901556	Cover Assembly (Items 1 - 10, 26)
	900698	Collar Assembly, 6" Tall (Items 11 - 25)
	901557	Complete Manhole Assembly (Items 1 - 26)



## SAFETY LATCH ASSEMBLY

ITEM	PART #	DESCRIPTION
41	B-384281	Safety Latch
42	B-070097	Pivot Block
43	095410	1/2" Flat Washer, S.S.
44	096208	Cotter Pin
45	A-384282	Hinge Pin, 1/2" Dia. x 5"

